



THE MAY FAIR

A RADISSON COLLECTION HOTEL

FLOORPLANS

Crystal Room, Danziger Suite, May Fair Theatre and Meeting Areas

FIRST FLOOR

- 1-11 Private Rooms
- BA Breakout Area
- BC Business Centre
- C Cloakroom
- L1 Lift to Ground and Lower Ground
- S1,2 Stairs to Ground and Lower Ground
- S3 Stairs down to the Salon Bar
- L3 Disabled Lift to Ground and Lower Ground

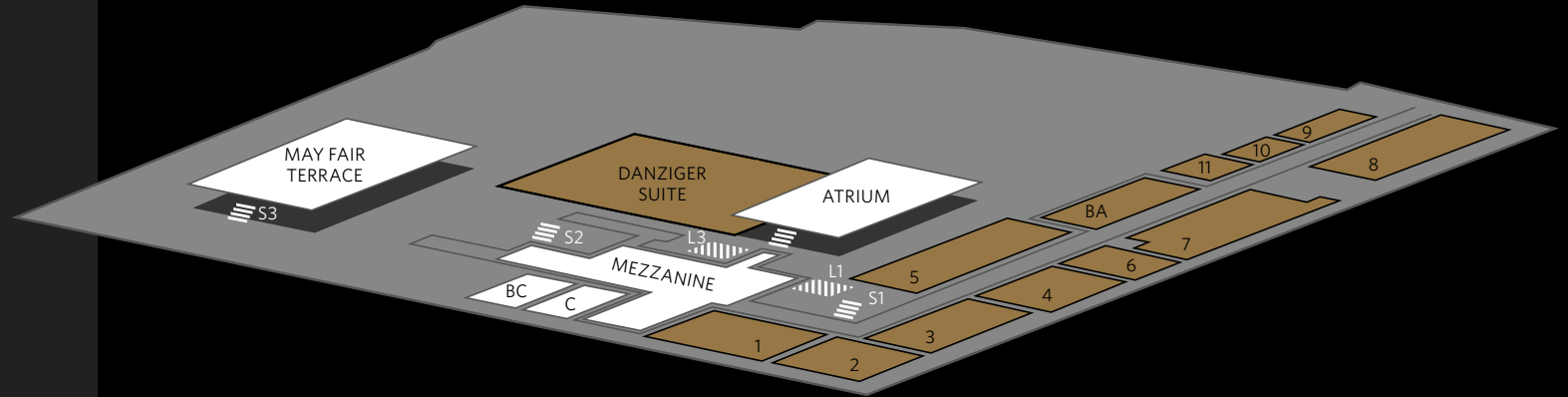

GROUND FLOOR

- E1 Entrance from Stratton Street
- E2 Entrance from Berkeley Street
- R Reception
- L1 Lift to First, Lower Ground and Bedrooms
- L2 Lift to All Upper Hotel Floors
- L3 Disabled Lift to First and Lower Ground
- S1 Stairs to May Fair Spa and First
- S2 Stairs to the May Fair Theatre and the Crystal Room
- S3 Stairs to the Cigar Lounge
- S4 Stairs down to the Crystal Room

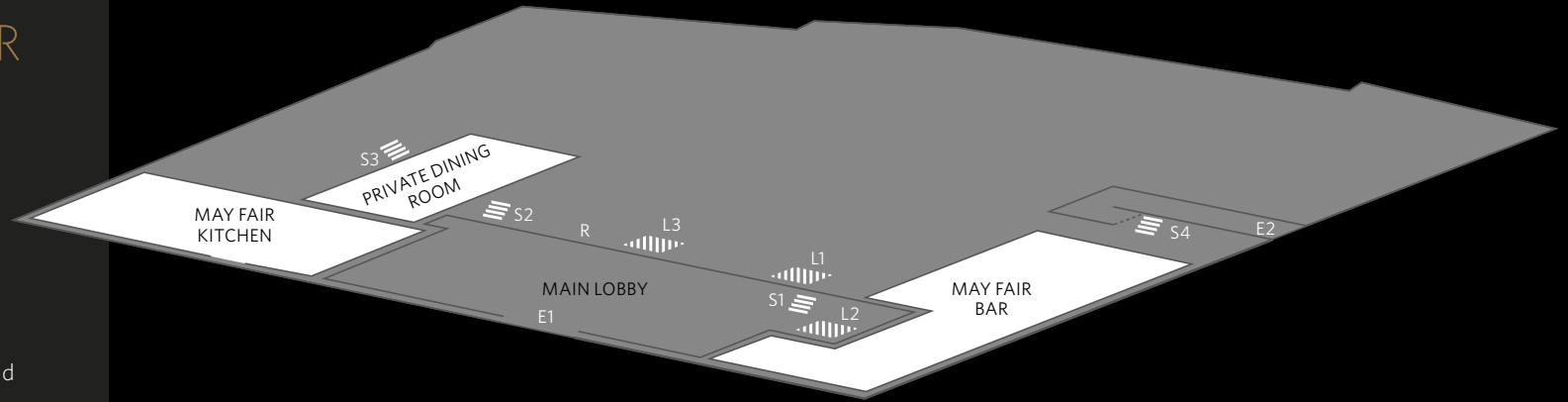

LOWER FLOOR

- S1,2 Stairs up to Reception and Main Lobby
- S4 Stairs up to Berkeley Street Exit
- L1 Lift to Ground and First
- L3 Disabled Lift to Ground and First

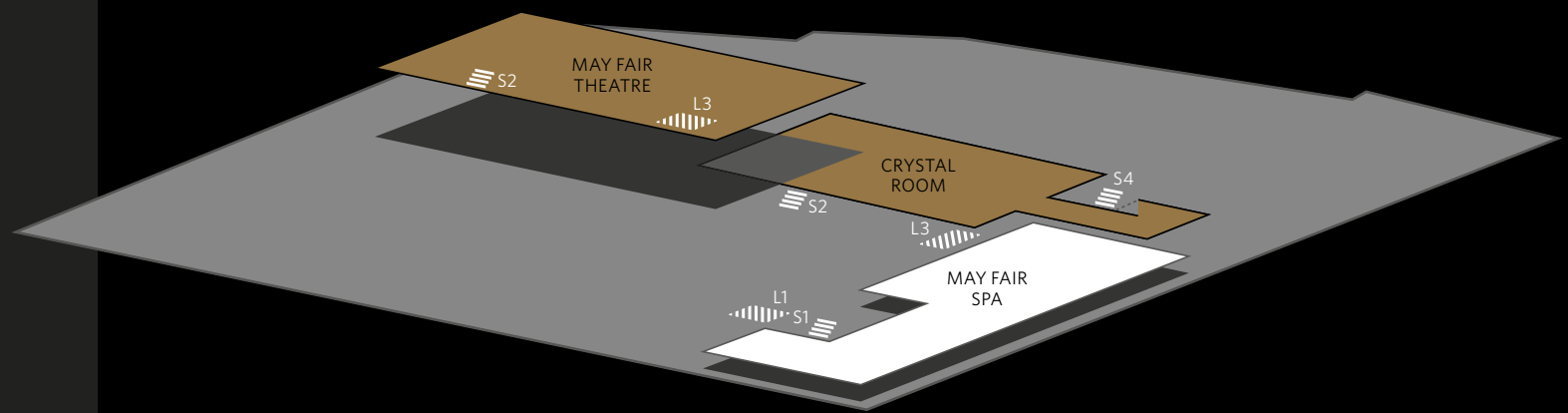



INTRODUCING THE MAY FAIR THEATRE AND CRYSTAL ROOM

The perfect combination for presentations or screenings followed by drinks and private dining in a beautiful ballroom setting.

One of the unique features of our event spaces is our beautiful theatre. Audiences of up to 201 guests sit in supreme comfort on Italian-leather trimmed seats complete with armrests and fold out tables, with ample leg room to stretch out. In front of the 8m screen a stage, available with optional speaker's podium, the May Fair theatre provides an energising and inspiring platform for multimedia presentations and filming location in London.

The Theatre works very well in combination with our Crystal Room, where guests can be entertained pre and post-presentation. A number of meeting rooms and suites as well as the May Fair Theatre's own Green Room can also be used as preparation spaces where speakers can follow events from the auditorium via live video and audio feeds.

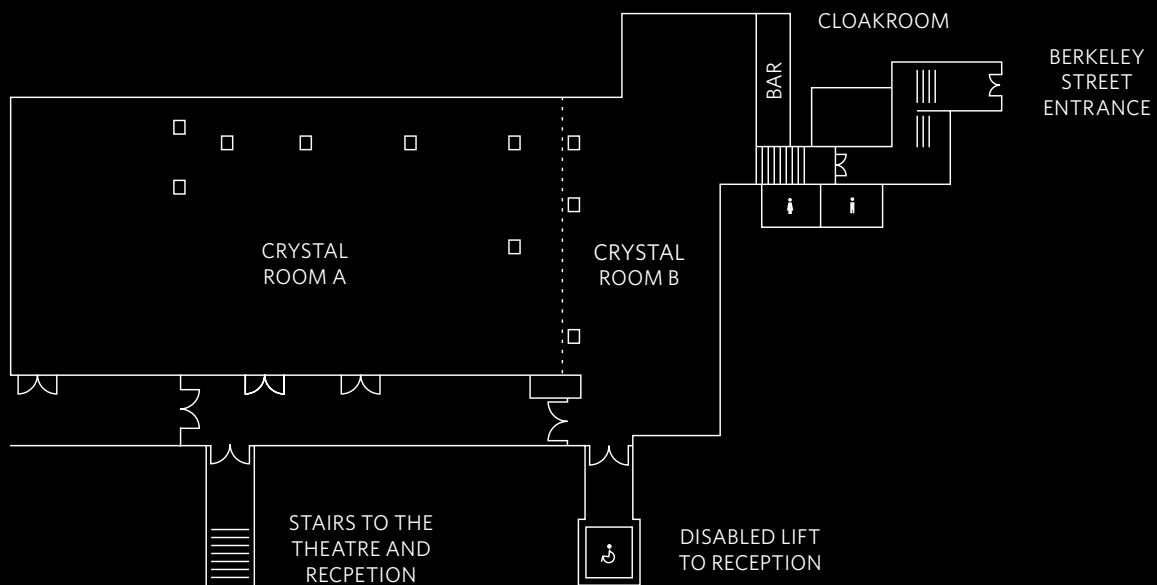

THE CRYSTAL ROOM

- Up to 300 theatre style or 220 for dinner
- Design features include bronze and lacquered walls and a baccarat chandelier
- Private entrance on Berkeley Street or via main lobby private bar
- Private access to May Fair Bar
- Private cloakroom
- Fully integrated av and lighting system

A. THEATRE STYLE
(UP TO 300 SEATS)

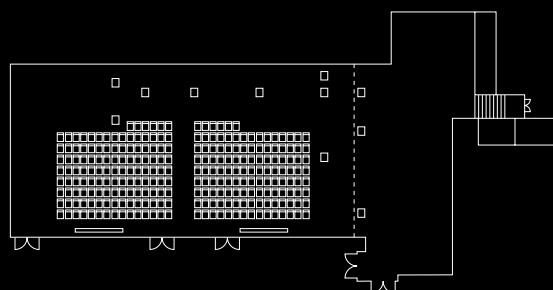

B. LUNCH/DINNER
(UP TO 220 SEATS)

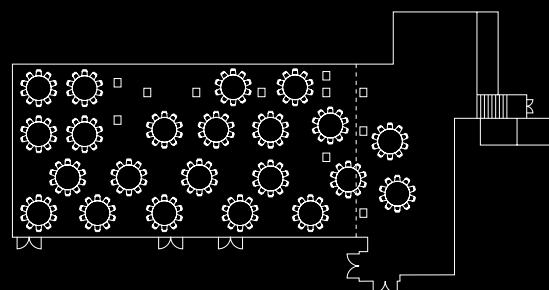

FIRST FLOOR

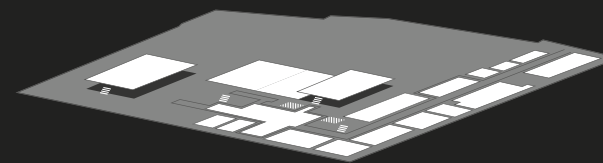

GROUND FLOOR

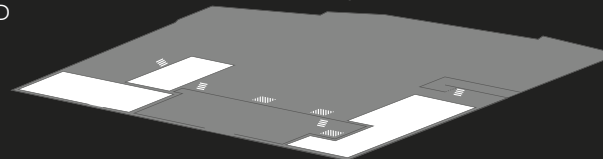

LOWER FLOOR

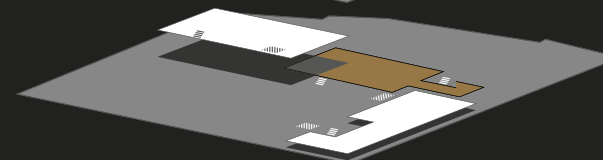

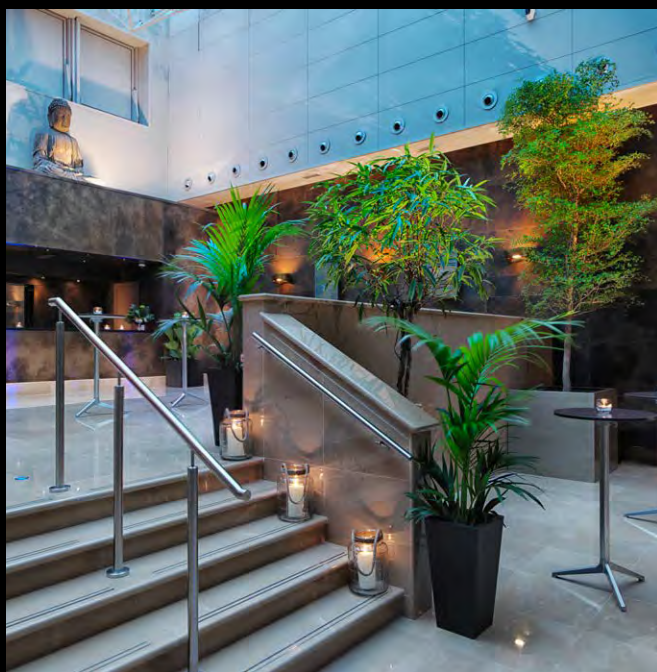

INTRODUCING THE MAY FAIR'S DANZIGER SUITE AND ATRIUM

The perfect combination for guests looking for and exclusive areas for and event and breakout or pre function space.

Seating 170 for dinner, with the flexibility to be divided into two rooms for conferences, events, smaller meetings and lunches, the Danziger mixes decadent Art Deco style with the latest LCD projection units to deliver a superbly flexible space. This is a space grounded in its practical use, with easily installed flexible stage for speaker events, conferences or concert performances.

Adjacent to The Atrium and in close proximity to private suites 1 to 11, planners can use the Mezzanine level as a truly flexible and contained event space, the atrium and the private rooms all offering beautiful spaces bathed in natural daylight.



A. THEATRE STYLE
UP TO 220 SEATS

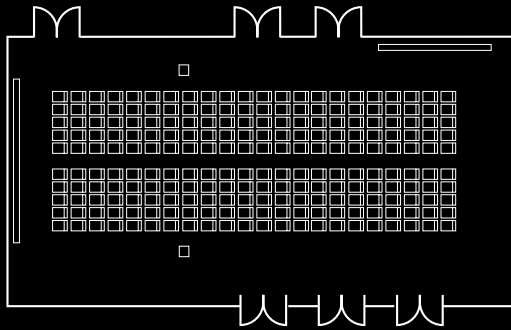

B. LUNCH/DINNER
UP TO 170 SEATS

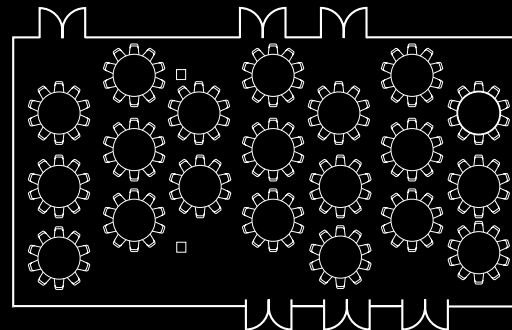

THE DANZIGER SUITE

- Up to 220 theatre style or 170 for dinner
- Located adjacent to naturally-lit atrium with private bar, opposite business centre and close to private rooms
- Fully integrated AV and lighting system

FIRST FLOOR

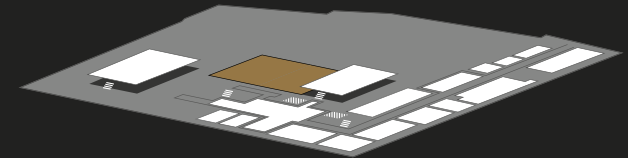

GROUND FLOOR

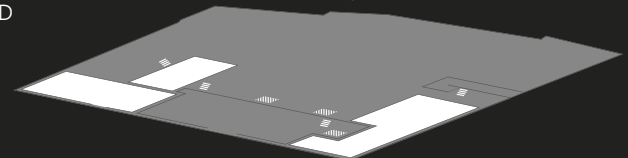

LOWER FLOOR

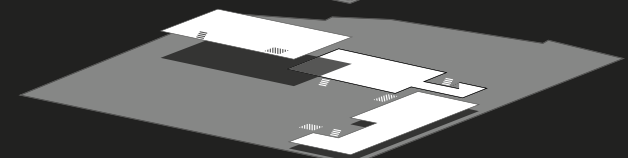



INTRODUCING MAY FAIR KITCHEN, THE TERRACE AND THE PRIVATE DINING ROOM

The perfect combination for guests looking for a discreet, stylish setting with an outdoor element.

The Private Dining Room is an exclusive private dining venue, tucked away in a discreet area of the hotel. Perfect for corporate dinners and smaller private functions, we offer quality food and a stylish environment for up to 72 guests dining and 100 guests for drinks receptions.

Adjacent to the May Fair Terrace, guests can have drinks before or after dinner in an intimate setting. Both areas are quietly located behind our May Fair Kitchen restaurant.

PRIVATE ROOM 1	L19.8m x W11.1m	600sq.ft
PRIVATE ROOM 2	L8.5m x W5.8m	513sq.ft
PRIVATE ROOM 3	L8.4m x W5.3m	480sq.ft
PRIVATE ROOM 4	L5.5m x W5.7m	336sq.ft
PRIVATE ROOM 5	L7.4m x W5.8m	461sq.ft
PRIVATE ROOM 6	L4m x W4.3m	184sq.ft
PRIVATE ROOM 7	L12.4m x W6.3m	840sq.ft
PRIVATE ROOM 8	L18.9m x W7.2m	1467sq.ft
PRIVATE ROOM 9	L7.8m x W3.6m	303sq.ft
PRIVATE ROOM 10	L4.2m x W3.7m	167sq.ft
PRIVATE ROOM 11	L4m x W4.1m	176sq.ft

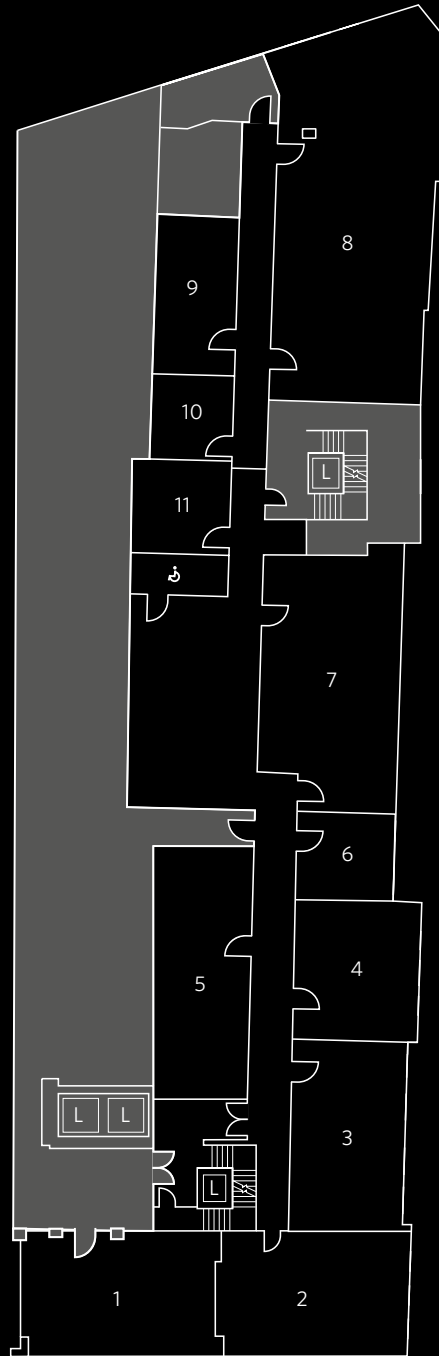

MEETINGS AREA

- Capacities from 6 to 120
- Fully integrated
- Av systems
- Natural daylight in the majority of rooms
- All rooms located together around
- A large central breakout area
- Individually designed spaces offering exclusive and discreet options for private dining

FIRST FLOOR

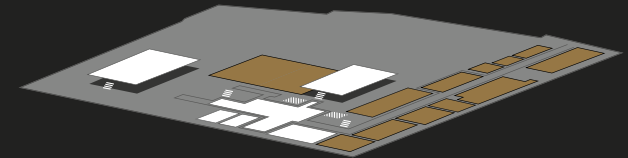

GROUND FLOOR

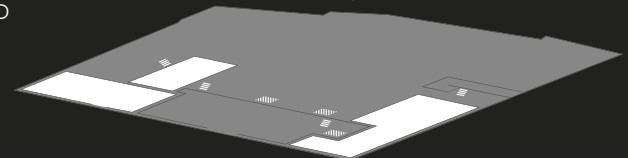

LOWER FLOOR

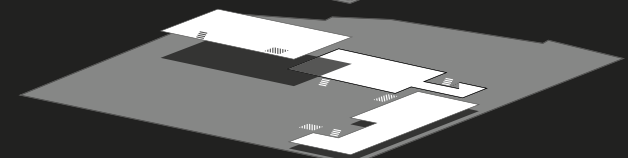

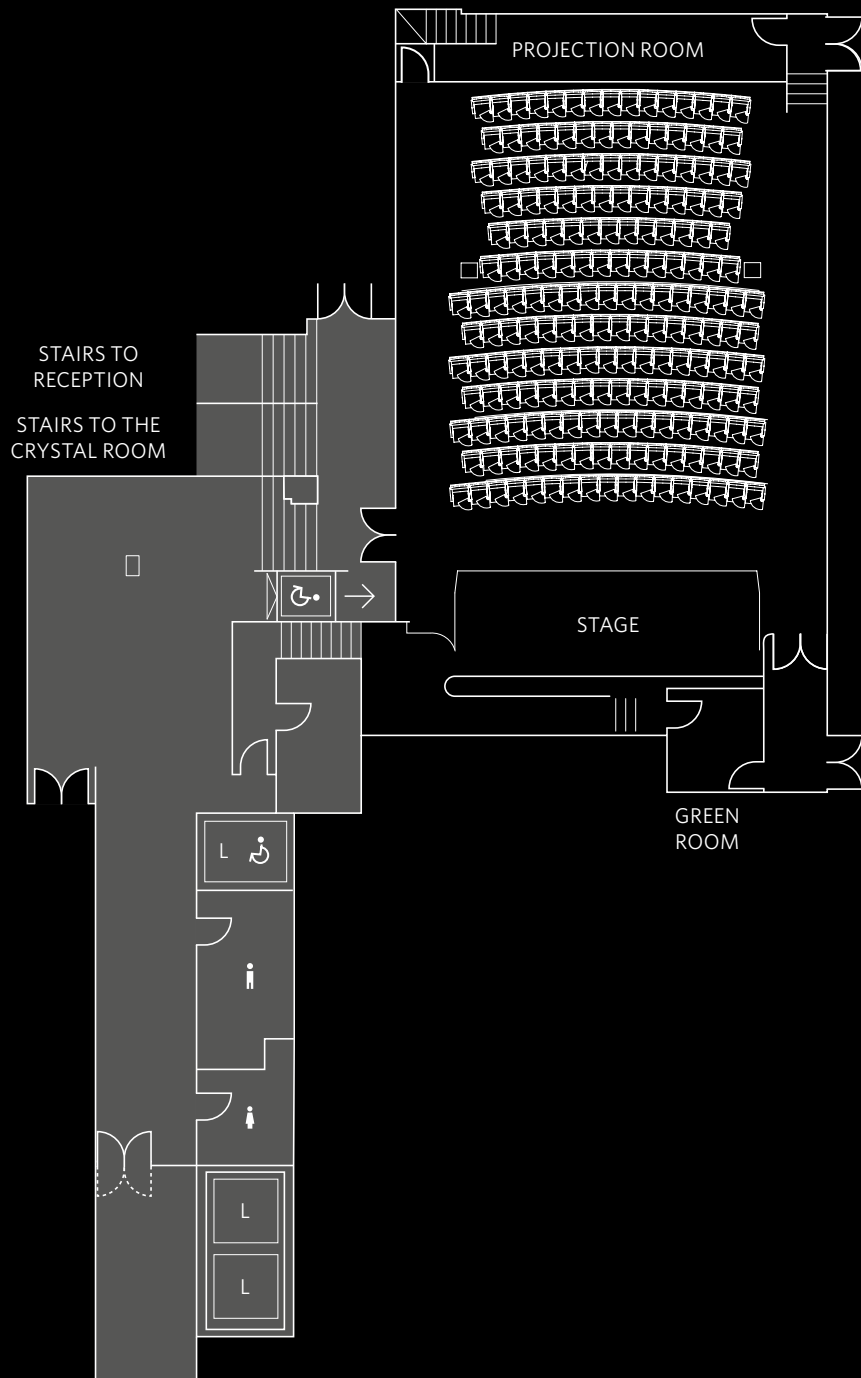

ACCESS TO
MAY FAIR
KITCHEN

THE MAY FAIR THEATRE

- 201 Custom-Designed italian leather seats
 - Retracting
 - Fold-out desks surround
 - Sound with thx certification
 - 8 X 3.8M adjustable screen
 - Barco 2k digital cinema projector
 - 4 Channel translation system
 - Stage lighting and control booth
 - Reald 3d
- Integrated IML interactive audience-response system featuring:
- Voting system
 - Text messaging and display system
 - Microphone system with audience-focused cameras
 - Video and audio feeds to all meeting rooms

FIRST FLOOR

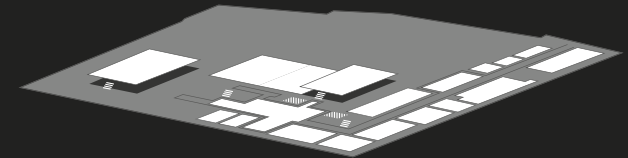

GROUND FLOOR

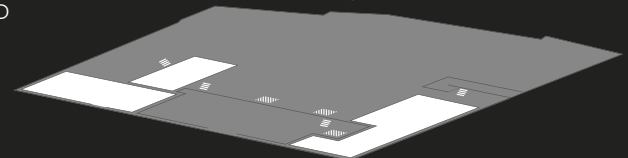

LOWER FLOOR

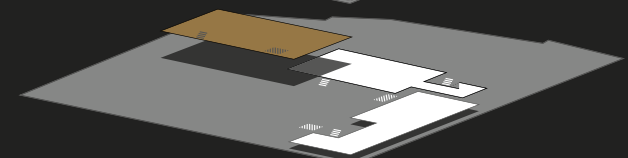

CONTACT US

The May Fair Hotel
Stratton Street, Mayfair
London, W1J 8LT

T +44(0)20 7915 3898

E events@themayfairhotel.co.uk

W themayfairhotel.co.uk



THE MAY FAIR

A RADISSON COLLECTION HOTEL